

Why Floating pumping station instead of Conventional Civil Jackwell Pumping Stations ?

For Comparison purpose we have taken case 1 typical 100 MLD Pumping Station scheme.

- **With Jackwell depth- 10 mtr**
- **Pumpset size 340 KW / 456 HP**
 - **Qty - 3 + 2 Pumpsets**

Jackwell Vs Pontoon Pump House



Sr. No.	Parameter	Conventional Jackwell Pump House	Pontoon Pump House
1.	Civil Construction Cost	18.5 Cr.	2 Cr.
2.	Electromechanical Cost	18 Cr.	18 Cr.
3.	Period of Completion	4 Years	6 Months
4.	Land requirement	Compulsory required	Not any land required
5	Land Acquisition	2 years More Complicated job	No land hence No land Acquisition required
6	Land Documentation	Required	Not required
7	Various Permissions	Required	Not Required
8	Leveling of Load	Required	Not Required
9	Success Ratio	Least Continuous water presence in Trench, Seepage water inside coffer dam Jackwell work get delayed.	100% Pontoon Pumping system work started it will definitely through without any obstacle.

Sr. No.	Parameter	Conventional Jackwell Pump House	Pontoon Pump House
10	Portability & Flexibility	In case of meandering of river we have to excavate new deep trench every time	In case of meandering of river pontoon pumping system can be relocated.

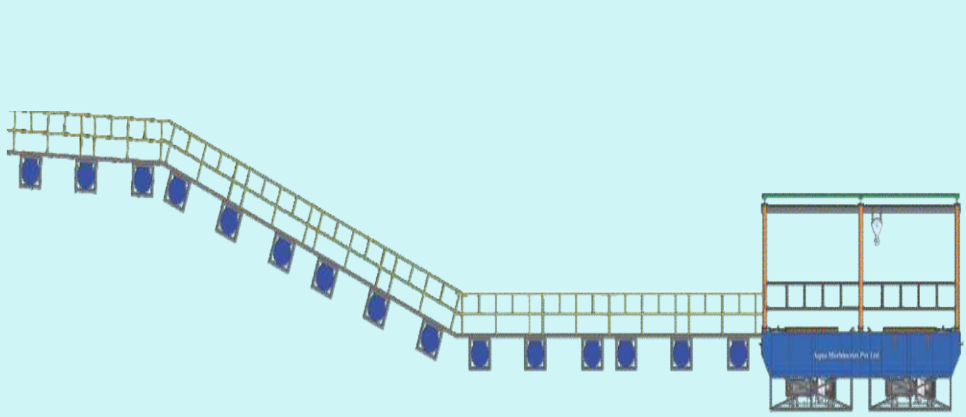

Sr. No.	Parameter	Conventional Jackwell Pump House	Pontoon Pump House
11	Operation & Maintenance of Pumpset	Pumpset can be replaced easily Small repairs can be done on Jackwell floor.	➤ Pumpset can be replaced easily ➤ Small repairs can be done on Pontoon floor. ➤ Separate service bay was provided on Potoon with EOT.
12	Suitability for type of pumps	- Vertical Turbine - End Suction - Submersible - HSCF	Pontoon pumping suitable for all type of pumps. - Vertical Turbine - End Suction - Submersible - HSCF Only design & pontoon is different for difficult pumps
13	IRS (Indian Register of Shipping) Certification	Not Applicable	IRS Certification required.
14	Stability of System	Good	Good With Proper design & Anchoring systems pontoon system is as good as conventional Jackwell Systems.

Sr. No.	Parameter	Conventional Jackwell Pump House	Pontoon Pump House
			
15	Water Level variation	Does not affect system	<p>Does not affect system</p> <p>Pontoon System smartly caters level variation.</p>
16	Flood Proof	These land based Jackwell system get flooded.	Pontoon systems eliminates Inundation & flooding issue.

Sr. No.	Parameter	Conventional Jackwell Pump House	Pontoon Pump House
17	Weather proof	System is good weather proof.	System is good weather proof.

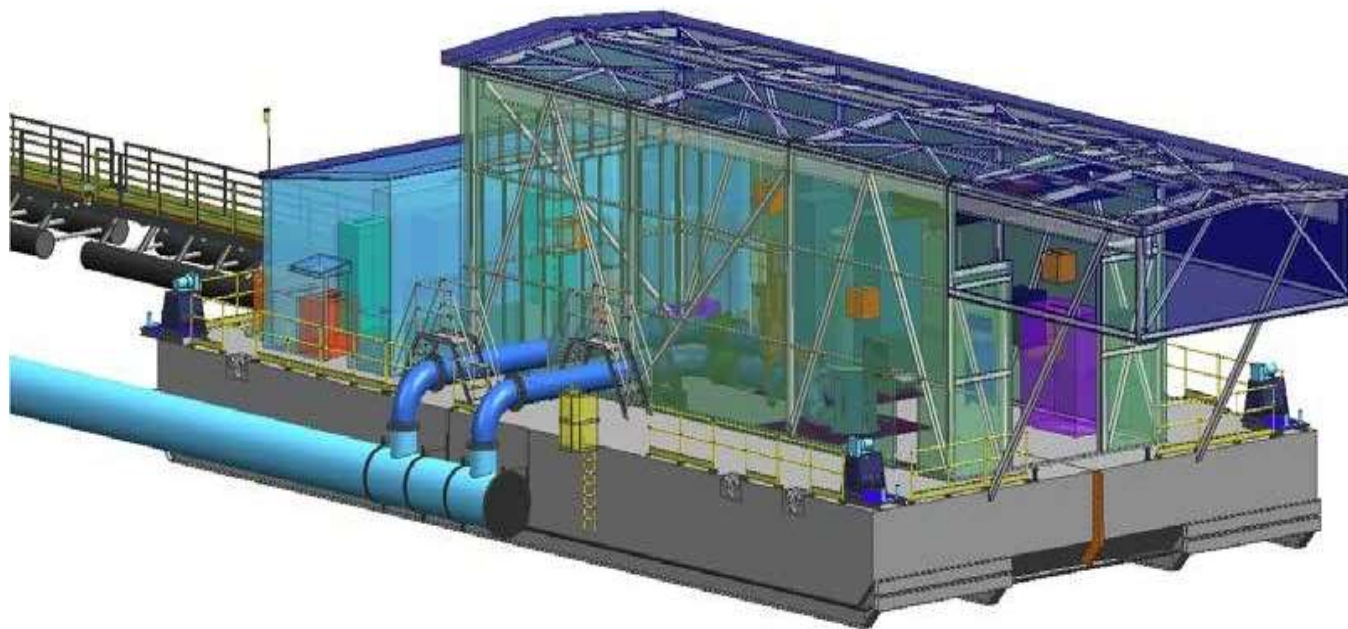

18	Safety to human & marine animals.	Not any hazards to marine life	Not any hazards to marine life
----	-----------------------------------	--------------------------------	--------------------------------